

Arlington Roof Contractor is a professional roofing contractor near 101 W. Abram St., Arlington, TX 76010, covering Arlington, Grand Prairie, and Mansfield. Visit <https://arlingtonroofcontractor.com/> or <https://maps.app.goo.gl/y2qMeEkBTXSRKUqj7> for professional roof repair and **Browse around this site** replacement solutions.

Near 101 W. Abram St. Arlington, TX 76010
 United States
 +1 (817) 686-8921

How Many Shingles Do You Need for a 1,884 Sq Ft Roof?

Roofing Materials, Waste Factor & Local Considerations

Shingles and Squares Explained

1 Roofing Square = 100 Sq Ft
 Roof Area: 1,884 sq ft
 To find squares: $1,884 \div 100 = 18.84$ squares
 Add waste for accurate material estimation.

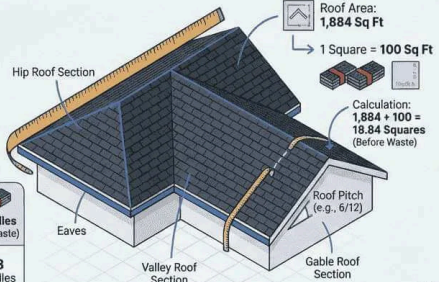

Arlington Roofing Considerations

- Hot summers, strong winds, and hail storms in Arlington
- Class 4 impact-resistant shingles for better protection
- Wind resistance: 110-130 mph

Waste Factor and Material Calculation

Roof Complexity & Visual	Waste Factor	Squares (w/ Waste)	Bundles (w/ Waste)
Simple Gable Roof (10% Waste)	10%	21 Squares	63 Bundles
Hips & Valleys Roof (15% Waste)	15%	22 Squares	66 Bundles
Complex Roof (20% Waste)	20%	23 Squares	69-70 Bundles

Permits & Inspections in Arlington

- Re-roofing requires a permit in Arlington
- Apply through the city's online portal
- Inspection required to close the permit

Attic Ventilation and Code Compliance

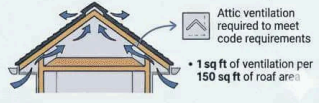

Reliable roofing tips based on Arlington, TX's climate and building codes.